

JONATHAN'S LANDING PLAT EIGHT

P.U.D.

88

DESCRIPTION

Being a parcel of land lying in Sections 6 and 7, Township 41 South, Range 43 East, Palm Beach County, Florida and being more particularly described as follows:

Commencing at the Southwest Corner of said Section 6; thence South 89°21' 43" East along the South-Line of said Section 6, a distance of 378.39 feet to a point on the Easterly Line of JONATHAN'S LANDING PLAT SIX, P.U.D., recorded in Plat Book 47, Page 10 and 11 of the Public Records of Palm Beach County, Florida, and the POINT OF BEGINNING of this description; thence North 50°59'03" West along said Easterly Line, a distance of 56.11 feet; thence North 61°49'32" West, a distance of 79.19 feet; thence North 19°58'30" East, a distance of 95.93 feet; thence North 83°15'00" West, a distance of 25.55 feet; thence North 01°31'37" East, a distance of 14.00 feet; thence North 45°33'20" East, a distance of 75.37 feet; thence North 61°56'31" East, a distance of 20.00 feet; thence South 88°30'45" East, a distance of 55.24 feet; thence North 89°40'56" East, a distance of 31.65 feet; thence South 76°16'53" East, a distance of 46.32 feet; thence departing said Easterly Line of JONATHAN'S LANDING PLAT SIX, South 73°44'12" East, a distance of 32.59 feet; thence South 45°52'12" East, a distance of 52.80 feet; thence South 57°32'14" East, a distance of 56.18 feet; thence South 48°16'09" East, a distance of 86.94 feet to a point on the Westerly Line of WATERBEND of JONATHAN'S LANDING-P.U.D., recorded in Plat Book 45, Page 7, of said Public Records; thence South 41°48'40" East, a distance of 110.86 feet; thence South 37°28'00" East, a distance of 24.59 feet to a point on the North Line of said Section 7; thence continue South 37°28'00" East, a distance of 82.30 feet; thence South 41°35'20" East, a distance of 103.81 feet; thence South 50°26'16" East, a distance of 139.72 feet; thence South 64°07'19" East, a distance of 109.80 feet; thence South 42°28'17" East, a distance of 168.81 feet; thence South 51°54'19" East, a distance of 162.83 feet; thence South 47°28'56" East, a distance of 134.19 feet; thence South 53°25'34" East, a distance of 140.90 feet to a point on the Westerly Line of JONATHAN'S LANDING PLAT TWO, P.U.D., recorded in Plat Book 35, Pages 20 and 21 of said Public Records; thence South 58°19'37" East, a distance of 212.26 feet; thence South 34°48'51" East, a distance of 146.77 feet; thence South 40°48'50" East, a distance of 84.98 feet; thence South 41°56'06" East, a distance of 37.36 feet; thence South 53°28'39" East, a distance of 74.27 feet; thence South 39°05'48" East, a distance of 35.60 feet; thence South 54°20'13" East, a distance of 16.09 feet; thence South 36°42'46" East, a distance of 33.87 feet; thence South 22°19'22" East, a distance of 28.76 feet; thence South 35°15'00" East, a distance of 8.80 feet; thence South 88°40'41" East, a distance of 57.00 feet; thence departing said Westerly Line of JONATHAN'S LANDING PLAT TWO, South 01°19'16" West, a distance of 23.33 feet; thence South 75°38'34" East, a distance of 4.98 feet; thence South 26°35'26" East, a distance of 14.11 feet; thence South 07°01'18" West, a distance of 22.13 feet; thence South 00°36'50" West, a distance of 19.32 feet; thence South 68°44'52" East, a distance of 12.20 feet; thence North 78°20'57" East, a distance of 42.22 feet; thence South 74°38'53" East, a distance of 42.30 feet; thence South 61°46'37" East, a distance of 94.27 feet; thence South 85°03'52" East, a distance of 41.48 feet; thence North 70°49'43" East, a distance of 53.30 feet; thence North 42°59'32" East, a distance of 75.36 feet; thence North 63°52'20" East, a distance of 53.28 feet; thence North 78°49'59" East, a distance of 40.67 feet; thence North 69°28'57" East, a distance of 50.01 feet; thence North 57°03'10" East, a distance of 64.01 feet; thence North 50°49'22" East, a distance of 131.76 feet; thence North 39°59'48" East, a distance of 160.90 feet; thence North 32°36'24" East, a distance of 100.80 feet; thence North 35°15'45" East, a distance of 79.16 feet; thence North 56°23'53" East, a distance of 46.74 feet; thence North 76°26'39" East, a distance of 56.66 feet; thence North 89°44'14" East, a distance of 52.09 feet; thence South 86°17'24" East, a distance of 47.38 feet; thence South 81°58'46" East, a distance of 102.08 feet; thence South 88°08'52" East, a distance of 58.26 feet; thence North 74°16'16" East, a distance of 50.01 feet; thence North 66°11'15" East, a distance of 159.04 feet; thence North 61°35'56" East, a distance of 85.28 feet; thence South 74°35'48" East, a distance of 20.38 feet; thence South 22°40'43" East, a distance of 100.87 feet; thence South 21°16'30" East, a distance of 72.06 feet; thence South 07°15'18" East, a distance of 71.52 feet; thence South 07°46'32" West, a distance of 43.77 feet; thence South 17°44'57" West, a distance of 47.72 feet; thence South 20°57'19" West, a distance of 48.75 feet; thence South 52°43'09" West, a distance of 49.48 feet; thence South 45°24'23" West, a distance of 48.75 feet; thence South 33°56'03" West, a distance of 54.15 feet; thence South 27°01'46" West, a distance of 280.01 feet; thence South 23°45'23" West, a distance of 93.70 feet; thence South 26°55'09" West, a distance of 44.94 feet; thence South 30°57'56" West, a distance of 108.36 feet; thence South 30°57'33" West, a distance of 48.32 feet; thence South 14°49'31" West, a distance of 33.34 feet; thence South 22°10'24" West, a distance of 38.46 feet; thence South 42°26'53" West, a distance of 40.53 feet; thence South 18°57'04" West, a distance of 10.76 feet; thence South 28°29'31" West, a distance of 50.09 feet; thence South 39°58'24" West, a distance of 37.50 feet; thence South 49°10'12" West, a distance of 43.29 feet; thence South 27°45'04" West, a distance of 50.21 feet; thence South 12°53'10" West, a distance of 50.77 feet; thence South 01°00'50" West, a distance of 34.92 feet; thence South 11°55'00" East, a distance of 32.24 feet; thence South 20°48'31" East, a distance of 52.12 feet; thence South 38°03'46" East, a distance of 49.70 feet; thence South 52°13'27" East, a distance of 55.35 feet; thence South 54°06'32" East, a distance of 56.24 feet; thence South 57°47'13" East, a distance of 53.35 feet; thence South 53°46'39" East, a distance of 51.69 feet; thence South 57°07'22" East, a distance of 103.69 feet; thence South 64°20'34" East, a distance of 113.90 feet; thence South 66°49'58" East, a distance of 53.15 feet; thence South 60°13'06" East, a distance of 47.46 feet; thence South 27°12'32" East, a distance of 32.76 feet; thence South 29°11'29" East, a distance of 46.46 feet; thence South 17°31'33" East, a distance of 74.91 feet; thence South 03°42'02" East, a distance of 19.22 feet to the Northeast corner of PARCEL "CC" of JONATHAN'S LANDING PLAT FOUR, P.U.D., recorded in Plat Book 41, Pages 183, 184 and 185 of said Public Records; thence North 88°14'54" West, along the North Line of said PLAT FOUR, a distance of 485.92 feet; thence South 86°03'37" West, a distance of 246.41 feet; thence North 88°14'54" West, a distance of 9.00 feet to a point on the Northerly Line of JONATHAN'S LANDING PLAT SEVEN, P.U.D., recorded in Plat Book 47, Pages 51 and 52 of said Public Records; thence South 72°21'45" West, along said Northerly Line, a distance of 113.52 feet; thence North 78°46'40" West, a distance of 229.04 feet; thence North 88°14'54" West, a distance of 23.00 feet to the beginning of a curve concave to the Northeast having a radius of 100.00 feet and a central angle of 90°00'00"; thence Westerly, Northwesterly and Northerly along the arc of said curve, a distance of 157.08 feet; thence North 60°33'07" West, radial to a curve to be described, a distance of 128.82 feet to a point on a curve concave to the Northwest having a radius of 250.00 feet and a central angle of 10°23'17"; thence Southwesterly along the arc of said curve, a distance of 45.33 feet; thence South 39°50'10" West along the tangent of said curve, a distance of 21.71 feet to the beginning of a curve concave to the Northwest having a radius of 340.00 feet and a central angle of 21°24'50"; thence Southwesterly along the arc of said curve a distance of 127.07 feet; thence South 61°15'00" West along the tangent of said curve, a distance of 115.68 feet to the beginning of a curve concave to the Southeast having a radius of 275.00 feet and a central angle of 59°47'50"; thence Southwesterly and Southerly along the arc of said curve, a distance of 287.01 feet; thence South 01°27'10" West along the tangent of said curve, a distance of 470.45 feet to the beginning of a curve concave to the Northwest having a radius of 125.00 feet and a central angle of 54°30'30"; thence Southerly and Southwesterly along the arc of said curve, a distance of 118.92 feet; thence South 55°57'40" West along the tangent of said curve, a distance of 257.17 feet; thence South 75°54' 25" West, a distance of 94.03 feet to the beginning of a curve concave to the Northeast having a radius of 190.00 feet and a central angle of 73°25'25"; thence Southwesterly, Westerly and Northwesterly along the arc of said curve a distance of 243.48 feet; thence North 30°40'10" West along the tangent of said curve, a distance of 685.55 feet to the beginning of a curve concave to the Northeast having a radius of 350.00 feet and a central angle of 14°02'51"; thence Northwesterly along the arc of said curve, a distance of 85.81 feet to a point of reverse curve concave to the Southwest having a radius of 60.00 feet and a central angle of 73°22'41"; thence Northwesterly and Westerly along the arc of said curve, a distance of 76.84 feet; thence WEST along the tangent of said curve, a distance of 194.60 feet to the beginning of a curve concave to the Northeast having a radius of 120.00 feet and a central angle of 91°08'10"; thence Westerly, Northwesterly and Northerly along the arc of said curve, a distance of 190.88 feet; thence North 01°08'10" East along the tangent of said curve, a distance of 470.03 feet to a point on the Southerly Line of TRACT 2 of said PLAT FOUR, said point lying on a curve concave to the Northeast having a radius of 57.00 feet and a central angle of 30°06'39"; the tangent to said curve bears North 40°47'07" West at this point; thence Southeast along the arc of said curve, a distance of 29.96 feet; the tangent to said curve bears South 70°53' 46" East at this point; thence North 01°45'06" East, a distance of 96.16 feet; thence North 88°14'54" West, a distance of 145.00 feet; thence North 01°45'06" East, a distance of 80.00 feet to the Southeast Corner of said JONATHAN'S LANDING PLAT SIX; thence continue North 01°45'06" East, a distance of 32.75 feet to the beginning of a curve concave to the Southwest having a radius of 57.00 feet and a central angle of 45°41'17"; thence Northwesterly and Northerly along the arc of said curve, a distance of 45.45 feet; the tangent to said curve bears North 43°56'11" West at this point; thence North 02°19'25" East, a distance of 793.22 feet to the beginning of a curve concave to the Southeast having a radius of 210.00 feet and a central angle of 64°45'55"; thence Northerly and Northeast along the arc of said curve, a distance of 237.38 feet; thence North 67°05'20" East along the tangent of said curve, a distance of 151.30 feet to the beginning of a curve concave to the Northwest having a radius of 280.00 feet and a central angle of 67°05'20"; thence Northwesterly and Northerly along the arc of said curve, a distance of 327.86 feet; thence NORTH along the tangent of said curve, a distance of 115.80 feet to the beginning of a curve concave to the Southwest having a radius of 150.00 feet and a central angle of 33°16'46"; thence Northerly and Northwesterly along the arc of said curve a distance of 87.12 feet; thence North 33°16'46" West along the tangent of said curve, a distance of 32.80 feet to the beginning of a curve concave to the Southwest having a radius of 150 feet and a central angle of 11°04'38"; thence Northwesterly along the arc of said curve a distance of 29.00 feet; thence North 44°21'24" West, a distance of 35.00 feet; thence North 38°26'22" West, a distance of 58.57 feet; thence North 44°48'43" West, a distance of 43.73 feet; thence North 51°09'31" West, a distance of 62.25 feet; thence North 56°45'07" West, a distance of 121.30 feet; thence North 67°13'46" West, a distance of 112.06 feet; thence North 64°09'34" West, a distance of 111.93 feet; thence North 50°59'03" West, a distance of 50.05 feet to the POINT OF BEGINNING.

IN PART OF SECTIONS 6 AND 7, TOWNSHIP 41 SOUTH, RANGE 43 EAST PALM BEACH COUNTY, FLORIDA IN FOUR SHEETS SHEET NO. 1

GEE & JENSON
ENGINEERS - ARCHITECTS - PLANNERS, INC.
WEST PALM BEACH, FLORIDA
FEBRUARY 1984

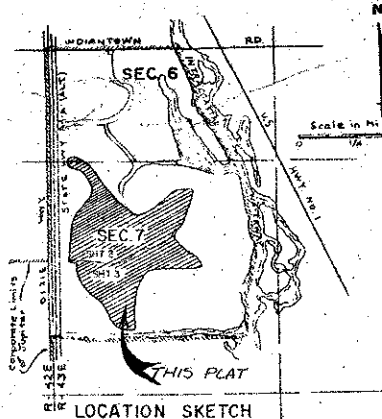

STATE OF FLORIDA
COUNTY OF PALM BEACH
This plat was filed for record at 11:28 AM, this 22 day of February, 1984, and duly recorded in Plat Book No. 48 on Pages 88, 89, 90, & 91.
JOHN B. DUNKLE
Clerk Circuit Court
By: *Margaret M. Mendenhall* D.C.

LAND USE

RESIDENTIAL PARCELS (7)	
PARCEL "A"	7.88 Acres
PARCEL "B"	5.52 Acres
PARCEL "C"	14.11 Acres
PARCEL "D"	6.98 Acres
PARCEL "E"	7.82 Acres
PARCEL "F"	10.91 Acres
PARCEL "G"	12.02 Acres
GOV COURSE	
CB	0.29 Acres
CT	4.30 Acres
CC	20.30 Acres
CC	12.97 Acres
OPN SPACE AND RECREATION	
PARCEL "HH"	0.13 Acres
PARCEL "JJ" (CLUBHOUSE)	2.59 Acres
DRAINAGE AND OPEN SPACE	
NS	19.12 Acres
NS	1.13 Acres
NS	0.63 Acres
ROAD LIGHT-OF-WAY	4.12 Acres
TOTAL	130.82 ACRES

NOTES

• denotes Permanent Reference Monument.
o denotes Permanent Control Point.

Building Setback Lines shall be as required by Palm Beach County Zoning Regulations.

No building or any kind of construction shall be placed on Utility or Drainage Easements.

No structures, trees or shrubs shall be placed on Drainage Easements.

Approval of landscaping on Utility Easements other than water and sewer shall be only with the approval of all utilities occupying same.

Easements are for Public Utilities unless otherwise noted.

Where Drainage Easements cross Cable Easements, Drainage Easements shall take precedence.

Bearings shown are relative to Intracoastal Waterway Map as recorded in Plat Book 17, Page 3-8 and used through JONATHAN'S LANDING

APPROVALS

PALM BEACH COUNTY
BOARD OF COUNTY COMMISSIONERS

This plat is hereby approved for record this 22 day of February, 1984.

By: *Ken Spillios* Chairman

Attest: *John B. Dunkle* Clerk

By: *H.F. Kohliert* Deputy Clerk

COUNTY ENGINEER

This plat is hereby approved for record this 22 day of February, 1984.

By: *H.F. Kohliert* County Engineer

TITLE CERTIFICATION

STATE OF FLORIDA
COUNTY OF PALM BEACH

I, PAUL C. WOLFE, a duly licensed attorney in the State of Florida do hereby certify that I have examined the title to the hereinafter described property; that I find the title to the property is vested in JONATHAN'S LANDING, INC., a Delaware Corporation; that current taxes have been paid and that the property is free of encumbrances.

Paul C. Wolfe
PAUL C. WOLFE, Attorney at Law
February 2, 1984

DEDICATION

STATE OF FLORIDA
COUNTY OF PALM BEACH

KNOW ALL MEN BY THESE PRESENTS, that JONATHAN'S LANDING, INC., a Delaware Corporation licensed to do business in the State of Florida, the owner of the land shown hereon as JONATHAN'S LANDING, PLAT EIGHT, P.U.D., lying in part of Sections 6 and 7, Township 41 South, Range 43 East, Palm Beach County, Florida, and being more particularly described to the left under "DESCRIPTION" have caused the same to be surveyed and platted as shown hereon and do hereby dedicate as follows:

The Road Rights-of-Ways, as shown are for private road purposes, ingress, egress, utilities and drainage; the Drainage Easements as shown are for the construction and maintenance of drainage facilities; the Fresh Water Parcels (FW5, FW6, FW7 and FW8) are for drainage and open space; PARCEL "HH" is for open space and recreation; All are hereby dedicated to the J. L. PROPERTY OWNERS ASSOCIATION, INC., its successors and assigns and are the perpetual maintenance obligation of said Association, its successors or assigns without recourse to Palm Beach County. The bridge easement as shown hereon, and PARCELS "JJ", CC6, CC7, CC8, CC9 and the Maintenance Area are for the purposes indicated and are the perpetual maintenance obligation of JONATHAN'S LANDING, INC., its successors or assigns without recourse to Palm Beach County, and are so dedicated.

Parcels R, S, T, U, V, W and Y are for the purposes indicated and are so dedicated. The Cable and Utility Easements as shown, including surfa and subsurface use, are hereby dedicated in perpetuity for the construction, operation, maintenance, inspection, replacement and repair of utility facilities, equipment and appurtenances for the benefit of J. L. PROPERTY OWNERS ASSOCIATION, INC.

IN WITNESS WHEREOF, the above named Corporation has caused these presents to be signed by its President and attested by its Assistant Secretary and its corporate seal to be affixed hereto by and with the authority of its Board of Directors, this 22 day of February, 1984.

Attest: *William A. Forman* Assistant Secretary
Richard W. Plovman President

ACKNOWLEDGEMENT

STATE OF FLORIDA
COUNTY OF PALM BEACH

BEFORE ME personally appeared Richard W. Plovman and William A. Forman, to me well known and known to me to be the individuals described in and who executed the foregoing instrument as President and Assistant Secretary of JONATHAN'S LANDING, INC., a Delaware Corporation, and severally acknowledged to and before me that they executed such instruments as such officers of said Corporation and that the seal affixed to the foregoing instrument is the corporate seal of said Corporation and that it was affixed to said instrument by due and regular corporate authority and that said instrument is the free act and deed of said Corporation.

WITNESS my hand and official seal this 22 day of February, 1984.

Richard W. Plovman
Notary Public

SURVEYORS CERTIFICATION

STATE OF FLORIDA
COUNTY OF PALM BEACH

KNOW ALL MEN BY THESE PRESENTS, that the undersigned does hereby certify that on 25 Feb 1984, that they completed the survey of lands as shown on the hereon plat; that said plat is a correct representation of the lands therein described and platted; that permanent reference monuments have been set as required by law and that permanent control points will be set under the guarantees posted with the Board of County Commissioners of Palm Beach County, Florida, for the required improvements and that the survey data complies with all the requirements of Part I, Chapter 177, Florida Statutes, as Amended and Minimum Technical Standards for Land Surveying in the State of Florida and Ordinances of Palm Beach County, Florida.

DAILEY AND ASSOCIATES

Paul H. Dailey
Paul H. Dailey, Professional Land Surveyor
Florida Registration No. 2439 Date: APRIL 25, 1984

SURVEYORS CERTIFICATION

STATE OF FLORIDA
COUNTY OF PALM BEACH

KNOW ALL MEN BY THESE PRESENTS that the undersigned does hereby certify that on Feb 3 1984, the hereon plat was prepared and delineated under my supervision and is a correct representation of the lands described as surveyed by DAILEY AND ASSOCIATES.

GEE & JENSON - Engineers, Architects, Planners, Inc.

THIS INSTRUMENT PREPARED BY STUART H. CUNNINGHAM
2090 Palm Beach Lakes Boulevard
West Palm Beach, Florida

Stuart H. Cunningham
Stuart H. Cunningham, Professional Land Surveyor
Florida Registration No. 3896

See Back

026-303

48/88

Jonathan's Landing

DRAWING NUMBER 88/88

DRAWING NUMBER

DRAWING NUMBER

DRAWING NUMBER